

## MATERIALS

Scissors  
 Tape or stapler  
 Glue stick  
 Sheets of 8 1/2" x 14" paper (this is to print the templates onto)  
 Colored sheets of card stock paper 8 1/2" x 14" paper (this paper is to make the helmet from)

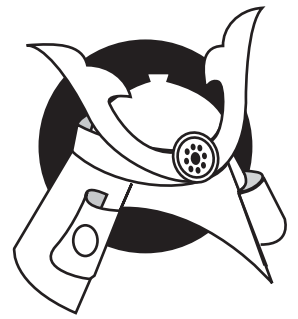

## SAMURAI HELMET Assembly Instructions

### PARTS

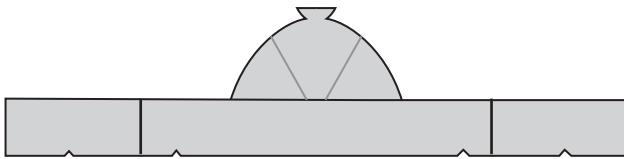

Headband

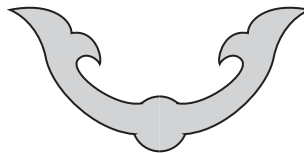

Horns

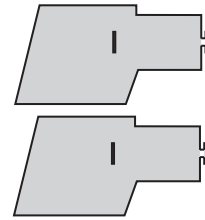

2 side flaps  
 (print one and trace twice)



3 of the same mon

**STEP 1:** Cut out Headband and Horns templates. Place template on folded piece of paper. Trace.

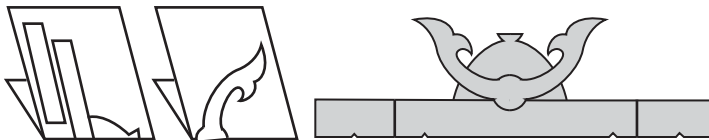

Cut out shapes.

Unfold and attach horns and attach band extensions.

Crimp helmet top on dotted line.

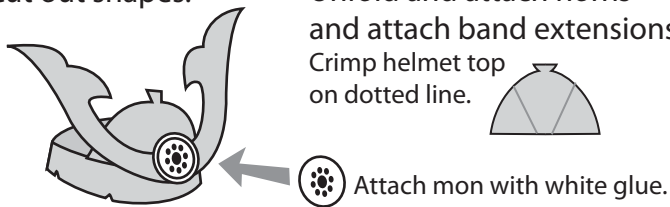

Attach mon with white glue.

Tape or staple back of band together. If needed, add extra paper to fit your head.

**STEP 2:** Cut out side flap template. Trace it twice onto paper and cut out.

Cut slots by folding paper slightly and snipping.

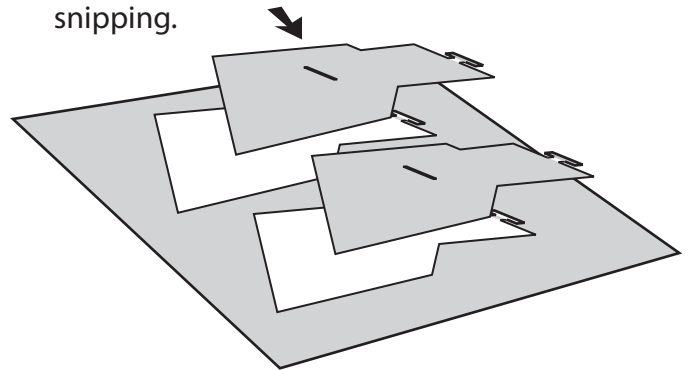

**STEP 3:** Using tape or staples, attach a side flap to each side of the headband. Attach top edge of side flap by slipping it behind the headband between the notches.

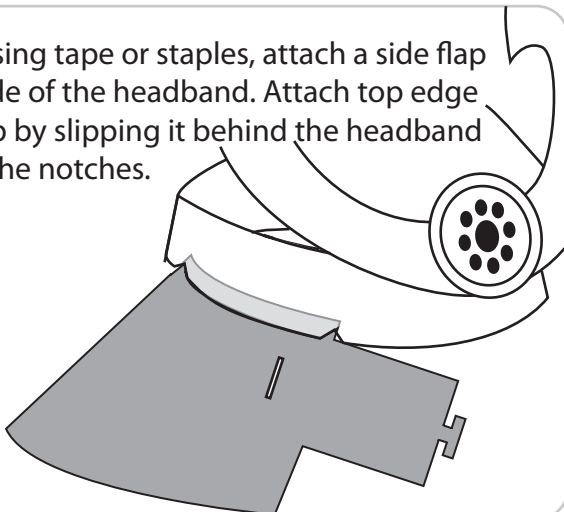

**STEP 4:** Fold the end of the tab over and slip into the side slot. Do this on both sides to create curled side flaps and tape down.

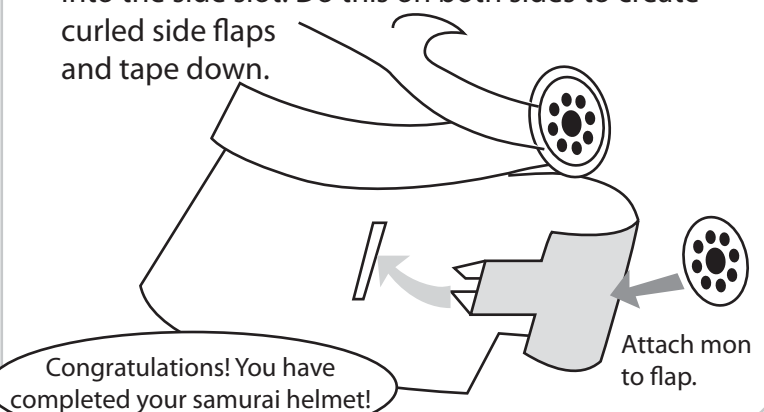

Congratulations! You have completed your samurai helmet!

Attach mon to flap.